

Edelstahl-Wandschränke

Abmessungen

Außenmaße (mm)			Abb.
A	B	C	
300	200	150	1
	250	150	1
	300	150	1
400	300	150	1
	300	200	1
	400	200	1
500	400	200	2*
	600	200	2
	600	250	2
700	500	250	2
	800	300	2
1000	800	300	3
	1000	300	4
1200	800	300	3
	1000	300	4

* ohne Türverstärkung.

DB300567EN-112



Abb. 1

DB300567EN-112

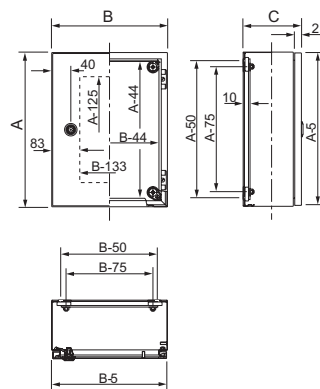

Abb. 2

DB300567EN-112

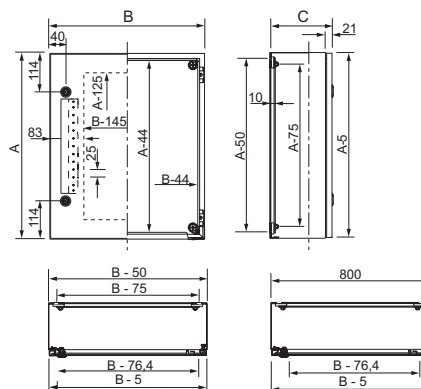

Abb. 3

DB300567EN-112

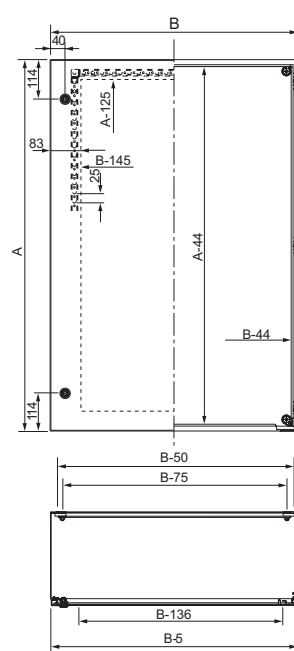
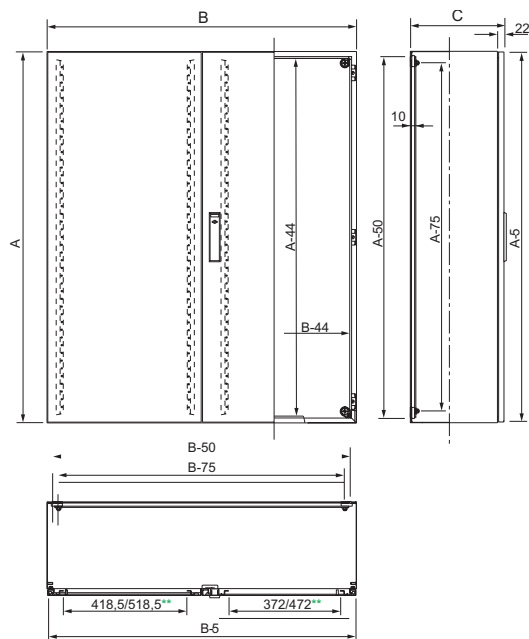

Abb. 4

** Für Sichttür.